



# WE International, Inc.

POST OFFICE BOX 97 • SYRACUSE, INDIANA 46567 USA  
PHONE: (219) 457-3066 • FAX: (219) 457-8807  
email: weexport@we-intl.com • <http://www.we-intl.com>

## Installation Sheet

# Basement Walls

## With Single Bubble Foil, Method #1

- Quick, easy and safe to install
- Provides reflective insulation for radiant heat loss or gain
- Blocks up to 97% of radiant heat during the winter
- 100% vapor proof - creates a vapor barrier
- Unaffected by moisture and humidity

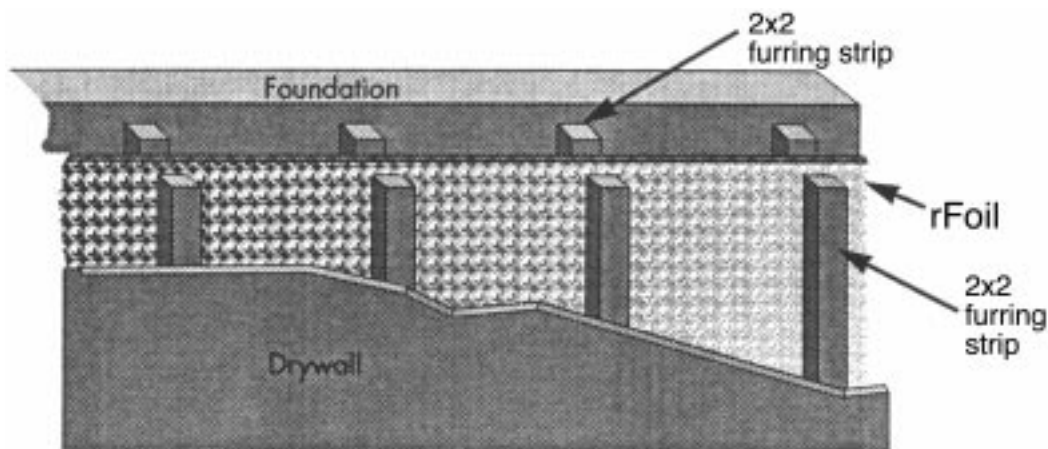

(It is important to remember that rFoil works best when there is a 1" airspace between rFoil and another material, like drywall or paneling. Since it is important to block heat leaving a building or house, the 1" airspace should be closest to the inside).

- 1) Attach 2x2 furring strips to basement/masonry wall with construction adhesive. Note: Regular 2x4s can be ripped on a table saw and used.
- 2) Tack rFoil horizontally to furring strips using staples. Pull it tight along the wall, but make sure the rFoil is not touching the basement wall.
- 3) Seal all seams with 2" Reflective Foil Tape (All tape should be applied using a flat edge taping tool to ensure good adhesion).
- 4) Fasten 2x2 furring strip over rFoil insulation using normal installation methods.
- 5) Attach drywall or paneling as usual.